

CODIGO **00300**

DESCRIPCION: **BOQUILLA ASPIRACION P. HORM. ENCOLAR D. 63**

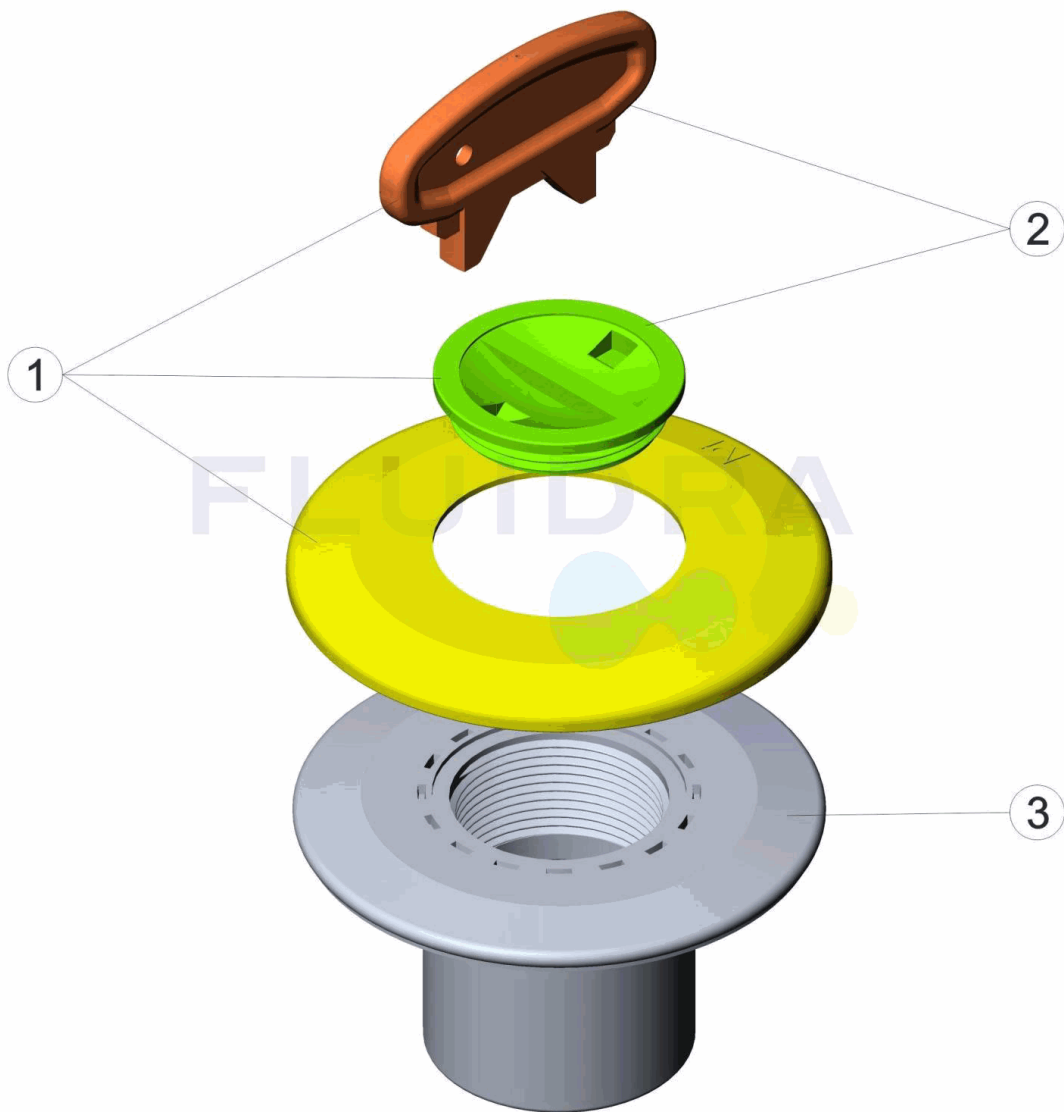

ESPAÑOL

POS	CODIGO	DESCRIPCION	POS	CODIGO	DESCRIPCION
1	4402040501	TAPON Y TAPETA BOQUILLA	3	00297R0001	BASE BOQUILLA IMPULSION
2	4402043101	TAPON BOQUILLA			

CODE **00300**

DESCRIPTION: **BOUCHE ASPIRATION P. BÉTON ENCOLLER D. 63**

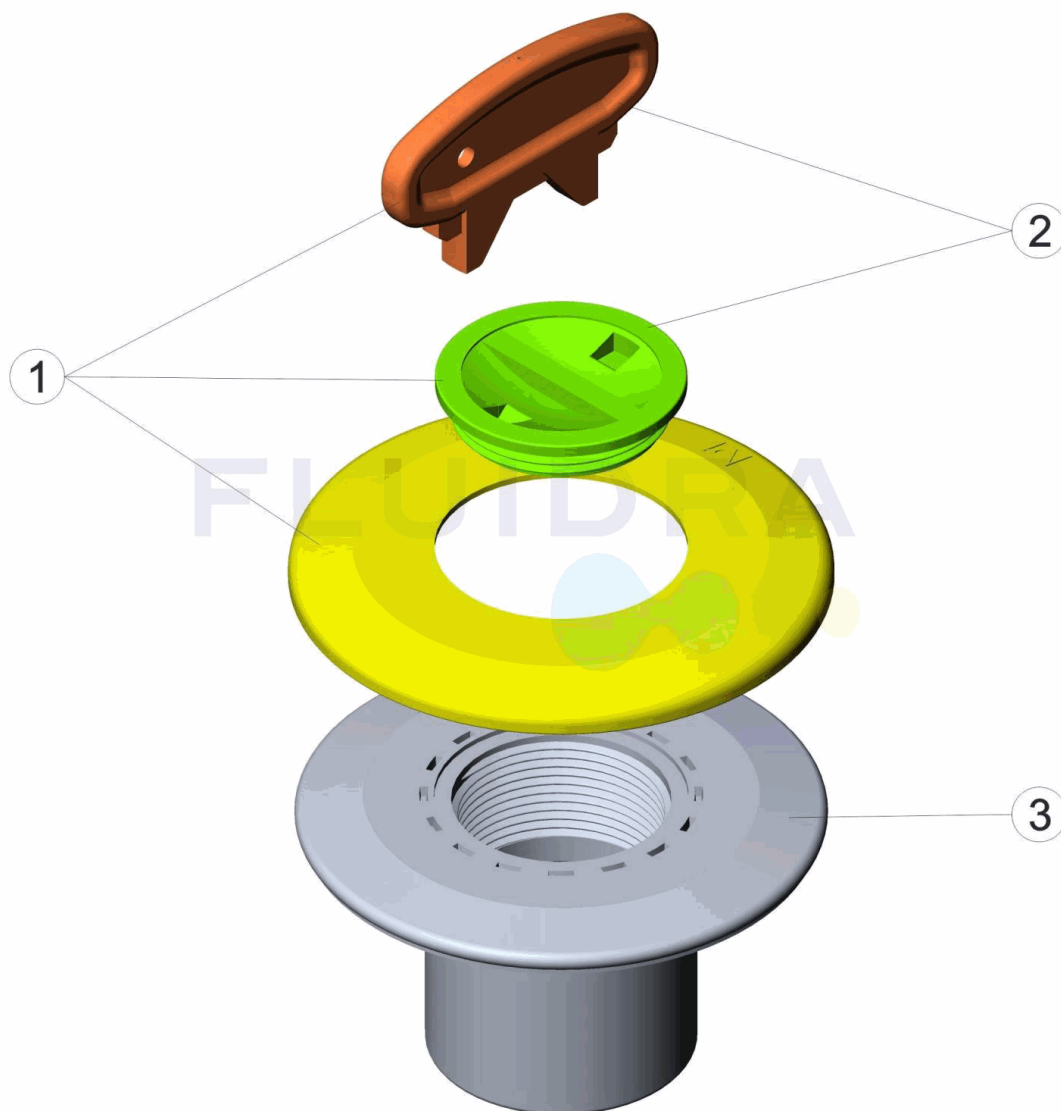

FRANCAIS

POS	CODE	DESCRIPTION	POS	CODE	DESCRIPTION
1	4402040501	BOUCHON ET COLLERETTE	3	00297R0001	CORPS DE LA BUSE
2	4402043101	BOUCHON DE BOUCHE			

CODE **00300**

DESCRIPTION: **SOLVENT-SEAL SUCTION NOZZLE CONCRETE POOL D. 63**

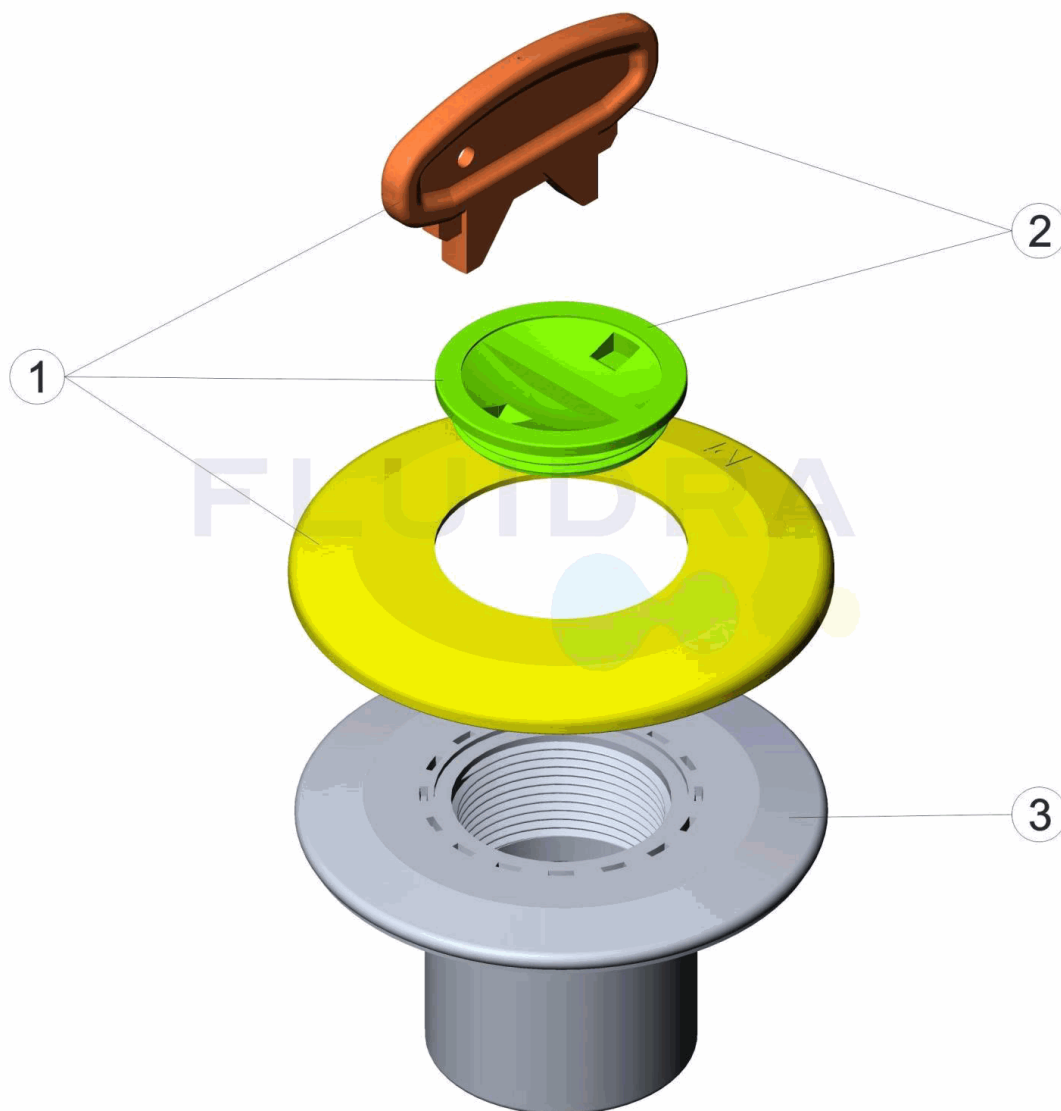

ENGLISH

POS	CODE	DESCRIPTION	POS	CODE	DESCRIPTION
1	4402040501	INLET COVER PLATE + CAP	3	00297R0001	INLET BASE
2	4402043101	INLET CAP			

CODICE **00300**

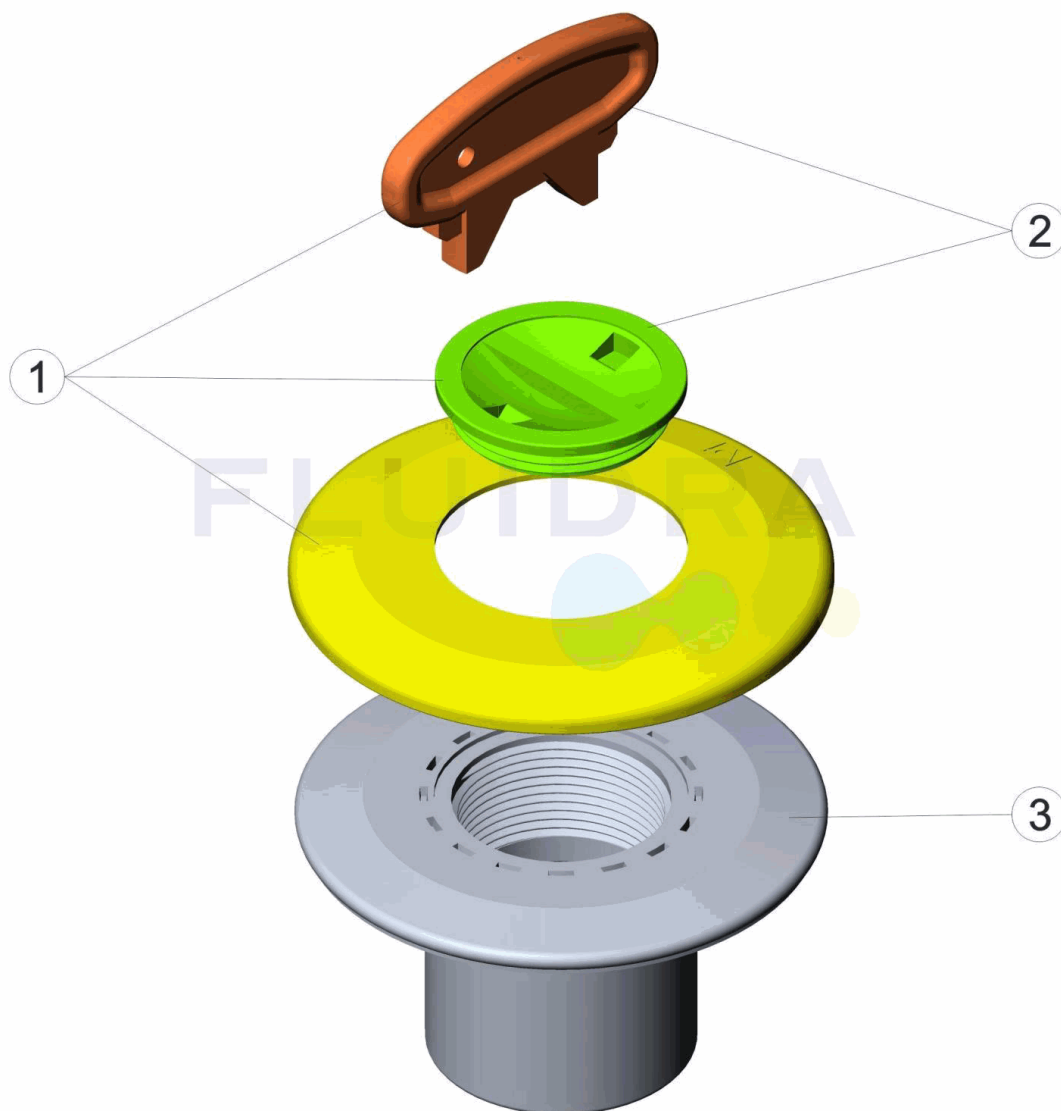
 DESCRIZIONE: **BOCCHETTA ASPIRAZIONE PISCINA CEMENTO INCOLLARE D. 63**

ITALIANO

POS	CODICE	DESCRIZIONE	POS	CODICE	DESCRIZIONE
1	4402040501	TAPPO E COPERCHIETTO BOCCHETTA	3	00297R0001	BASE BOCCHETTA
2	4402043101	COPERCHIO BOCCHETTA			

CODE **00300**

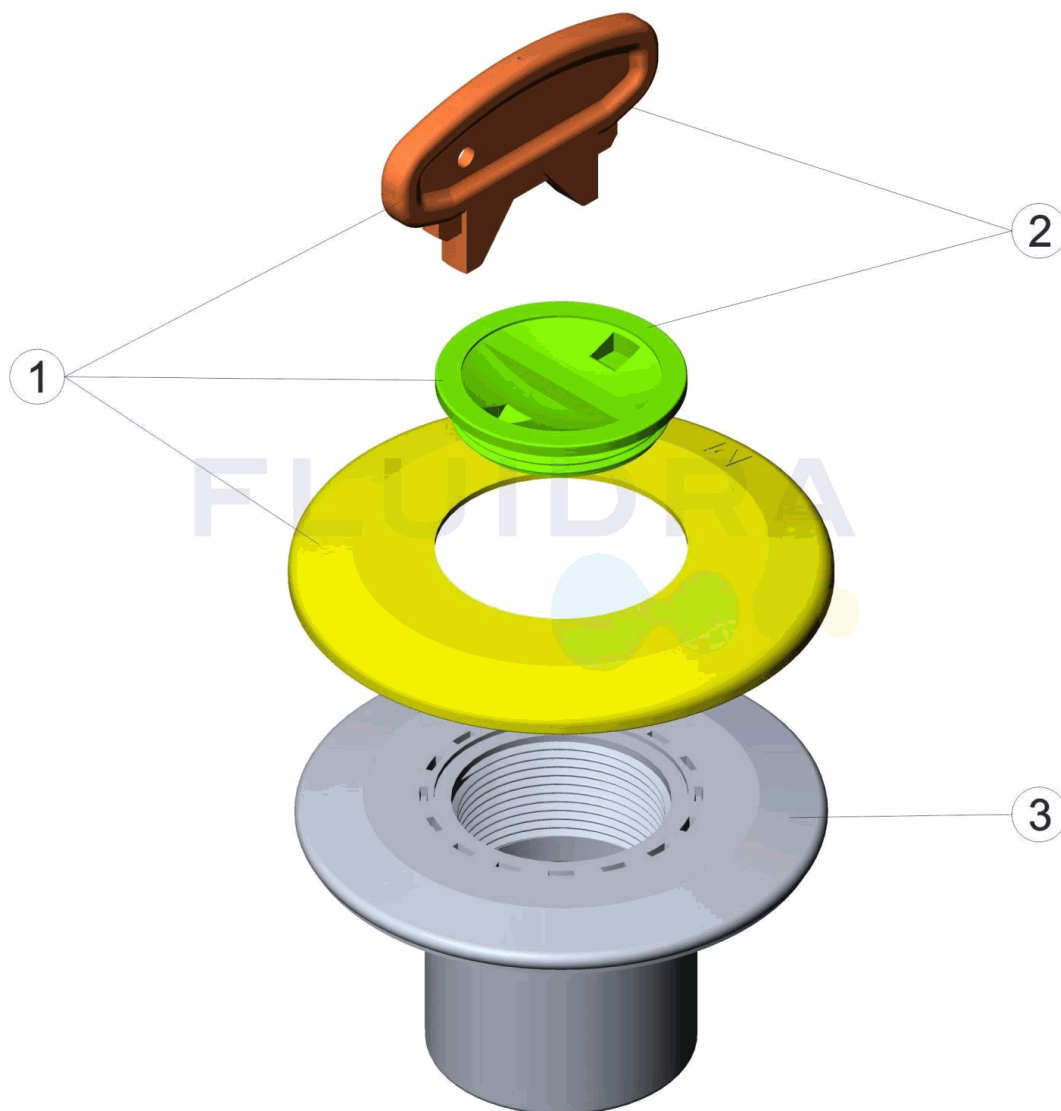
BESCHREIBUNG: **ANSAUGDÜSE BETONBECKEN KLEBEN D. 63**



DEUTSCH

POS	CODE	BESCHREIBUNG	POS	CODE	BESCHREIBUNG
1	4402040501	VERSCHLUSSSTOPFEN ABS SAUGANSCHLUSS	3	00297R0001	GRUNDELEMENT DÜSE
2	4402043101	VERSCHLUSSKAPPE SAUGANSCHLUSS			

CODIGO **00300**

DESCRIÇÃO: **BOQUILHA ASPIRAÇÃO P. BETÃO UNIR D. 63**

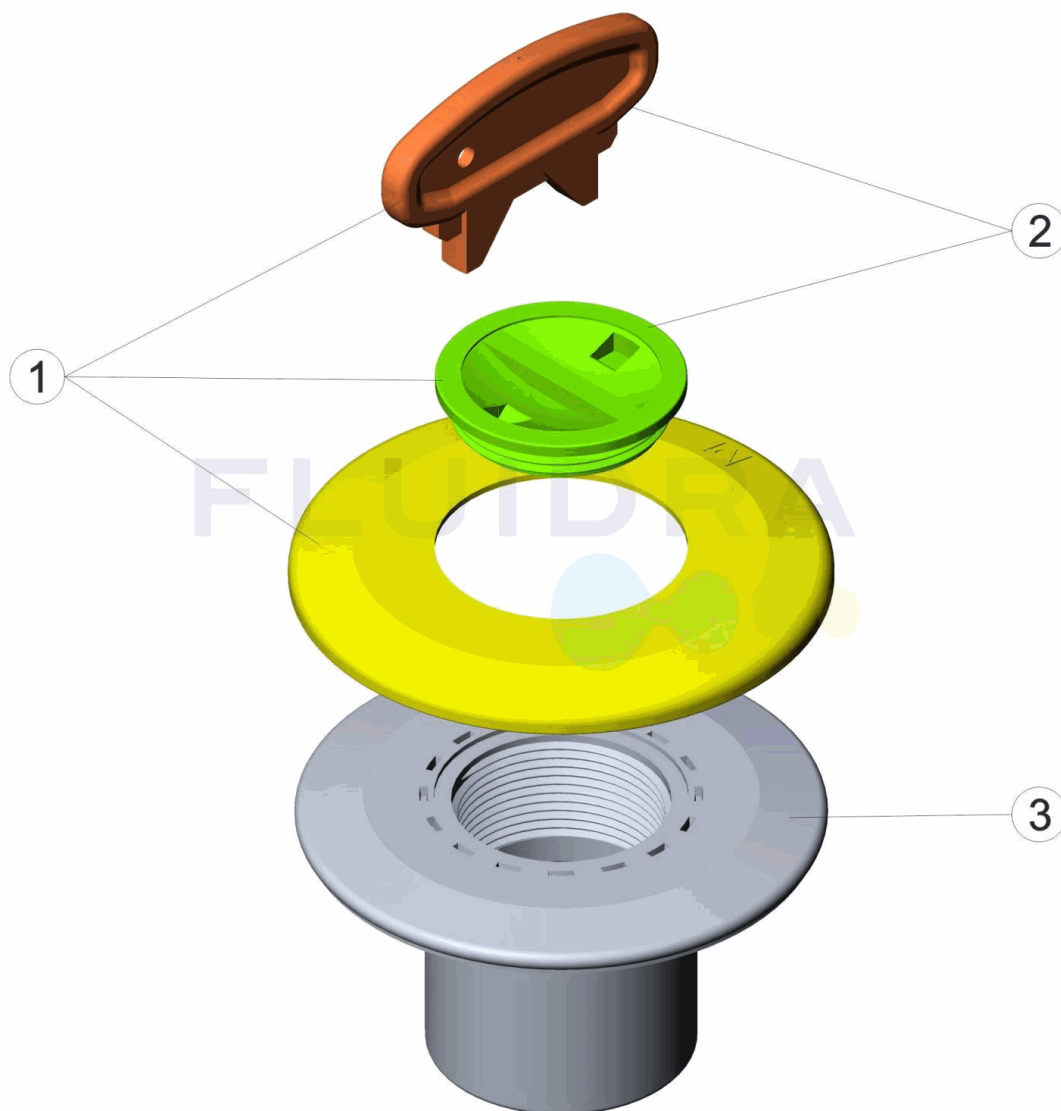

PORTUGUES

POS	CODIGO	DESCRIÇÃO	POS	CODIGO	DESCRIÇÃO
1	4402040501	TAMPÃO DE BOCA	3	00297R0001	BASE BOCA
2	4402043101	TAMPÃO BOCA			